

Take Control Unit TCU100. Related Product Options

PROTECTED MAINS VOLTAGE SUPPLY 230V

CONTROL SIGNAL 0-10V - ONLY ONE CONTROL SIGNAL OPTION TO BE CONNECTED

A SINGLE 15V OR 24V POWER SUPPLY IS REQUIRED

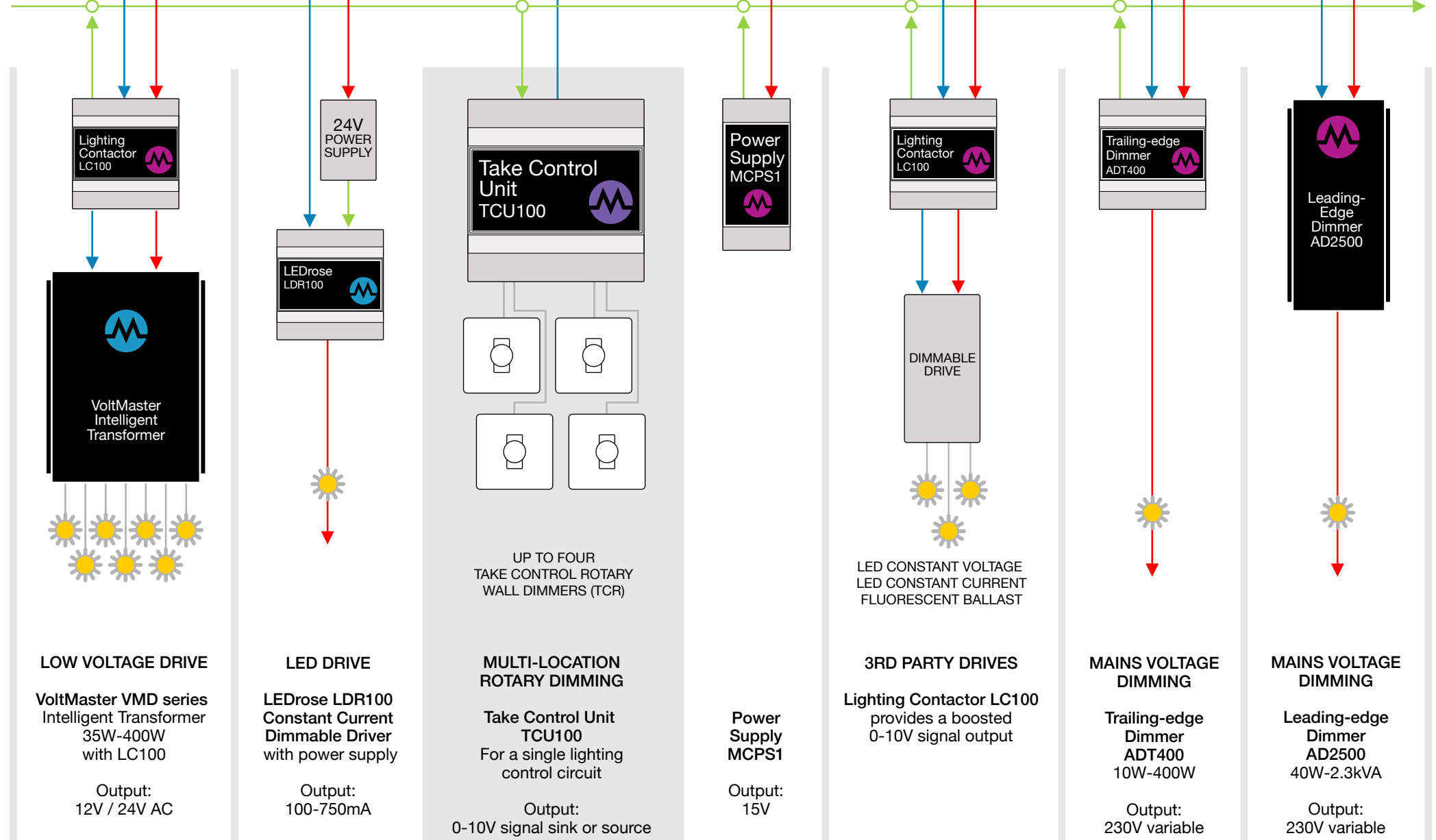

LOW VOLTAGE DRIVE

VoltMaster VMD series
Intelligent Transformer
35W-400W
with LC100

Output:
12V / 24V AC

LED DRIVE

LEDrose LDR100
Constant Current
Dimmable Driver
with power supply

Output:
100-750mA

MULTI-LOCATION ROTARY DIMMING

Take Control Unit
TCU100
For a single lighting
control circuit

Output:
0-10V signal sink or source

Power
Supply
MCPS1

Output:
15V

3RD PARTY DRIVES

Lighting Contactor LC100
provides a boosted
0-10V signal output

LED CONSTANT VOLTAGE
LED CONSTANT CURRENT
FLUORESCENT BALLAST

MAINS VOLTAGE DIMMING

Trailing-edge
Dimmer
ADT400
10W-400W

Output:
230V variable

MAINS VOLTAGE DIMMING

Leading-edge
Dimmer
AD2500
40W-2.3kVA

Output:
230V variable