

LEDrose LDR100. Related Product Options

PROTECTED MAINS VOLTAGE SUPPLY 230V

CONTROL SIGNAL 0-10V - ONLY ONE CONTROL SIGNAL OPTION TO BE CONNECTED

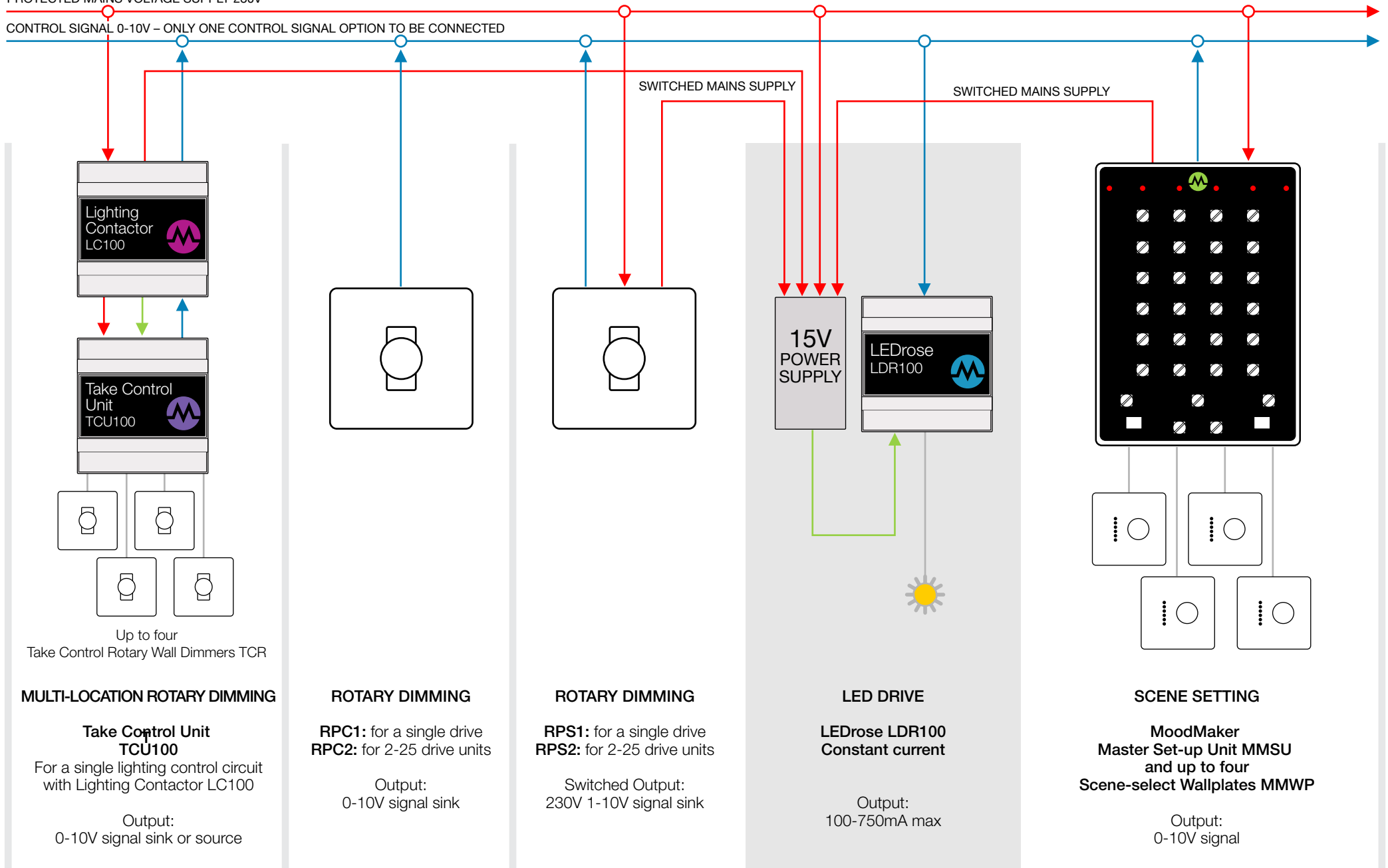

MULTI-LOCATION ROTARY DIMMING

Take Control Unit TCU100

For a single lighting control circuit with Lighting Contactor LC100

Output:
0-10V signal sink or source

ROTARY DIMMING

RPC1: for a single drive
RPS2: for 2-25 drive units

Output:
0-10V signal sink

ROTARY DIMMING

RPS1: for a single drive
RPS2: for 2-25 drive units

Switched Output:
230V 1-10V signal sink

LED DRIVE

LEDrose LDR100
Constant current

Output:
100-750mA max

SCENE SETTING

MoodMaker
Master Set-up Unit MMSU
and up to four
Scene-select Wallplates MMWP

Output:
0-10V signal