

Trailing-edge Dimmer ADT400. Related Product Options

PROTECTED MAINS VOLTAGE SUPPLY 230V

CONTROL SIGNAL 0-10V – ONLY ONE CONTROL SIGNAL OPTION TO BE CONNECTED

SELV 15V POWER SUPPLY

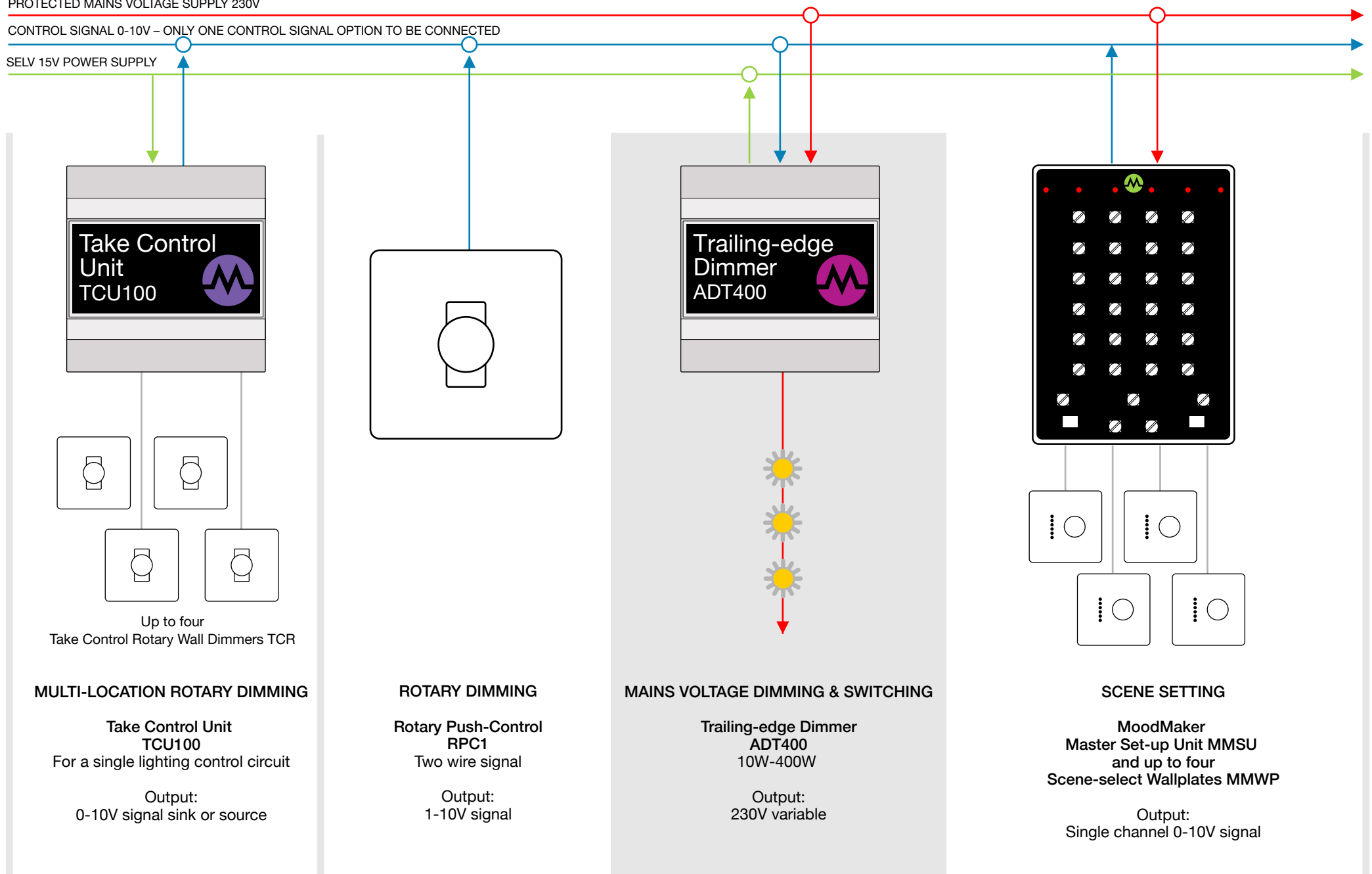

MULTI-LOCATION ROTARY DIMMING

Take Control Unit
TCU100
For a single lighting control circuit

Output:
0-10V signal sink or source

ROTARY DIMMING

Rotary Push-Control
RPC1
Two wire signal

Output:
1-10V signal

MAINS VOLTAGE DIMMING & SWITCHING

Trailing-edge Dimmer
ADT400
10W-400W

Output:
230V variable

SCENE SETTING

MoodMaker
Master Set-up Unit MMSU
and up to four
Scene-select Wallplates MMWP

Output:
Single channel 0-10V signal